



NICTD West Lake Corridor Project Construction Update

Week of 5.15.2023 & 5.22.2023

Hammond

- **Closures**
 - Russel Street (between Hohman Avenue and Lyman Avenue)
 - Closure is currently active.
 - See Attached Detour.
 - 165th Street
 - Traffic has been detoured to North half of 165th with one lane in East and West direction.
 - ⑩ Please see attached lane closure details.
 - Highland Street
 - Closure from May 15th to 19th
 - See attached detour.
 - Detroit Street
 - Closure from May 22nd to May 26th
 - See attached detour.
- **Utility Relocation, Sewer & Water**
 - Drainage Removals/Installation
 - Future Hammond Gateway Station
 - ⑩ No impact to vehicular traffic
- **Retaining Wall Between Fayette and Douglas Street**
 - Receiving Modular Concrete Blocks
 - Trucking Operations through City of Hammond roadways, minimal impact to vehicular traffic.
 - Framing for concrete.
 - Setting and Backfilling Concrete Blocks
- **Retaining Wall at Blaine between 165th Street and Kenwood Street**
 - Guardrail installation in coming weeks.
- **Monon Trail Closure**
 - Monon closed from Douglas Street to Little Calumet River.
 - Closed indefinitely until rail operation has been complete.
 - No connection to Lackawanna Trail.
- **Rail Construction**

- Contractor to begin setting rail from South of Douglas Street to Highland Street over the next three.
 - Weekly intersections closures starting at Waltham Street moving South. More information will be distributed as closures are approved.
- Hanover Street will be permanently closed between Wabash and Sheffield Avenues.
- Dearborn at Gostlin Street will be closed permanently.
- **Substructure Work for Bridges, Elevated Structures, and Retaining Walls**
 - Parkway near Michigan Avenue and Hohman Avenue
 - Steel Erection for Bridge Structures over Sibley Street

Munster

- Closures
 - Manor Avenue (Between Ridge Road and Broadmoor Avenue)
 - Closure from May 22nd – May 3rd.
 - See attached detour.
- NIPSCO & Telecommunications Relocations.
- Retaining Wall between Little Calumet River and Broadmoor
 - Retaining Wall excavation/framing/pouring continues along Manor Ave. North and South of Broadmoor.
 - Trucking operations through the Town of Munster, minimal impact to vehicular traffic.
- Monon Trail will be closed for the foreseeable future from Little Calumet River to Fisher Street
 - Closure will last until rail operation is complete from Fisher-Ridge.
 - Closure will last until retaining walls are complete from Ridge to Little Calumet.
 - Noise Wall construction on Monon Trail, between Fisher and Ridge, to begin on 5/3/2023.
- Ongoing underground utility installation through mid-April.
- Structure work at the Little Calumet River.
 - Trucking operations on Manor Avenue, minimal impact to vehicular traffic.
- Station Work
 - Munster-Ridge station
 - Setting station platform and ramps.
- **Utility Relocation: Storm, Sanitary & Water**
 - Drainage Installation between Fisher Street and Ridge Road along Monon Trail
 - No impact to vehicular traffic
 - Drainage Installation near CSX track and Superior Avenue.
 - No impact to vehicular traffic

Dyer

- No active work at this time.

**For additional project information please visit:
www.nictdwestlake.com or www.fhp-rb.com**

HIGHLAND ST. WESTBOUND DETOUR



Legend

- Vehicle Detour - - - - -
- Work Zone
- Type III Barricade
- Traffic Pattern



END
DETOUR

DETOUR

SIDEWALK
CLOSED

DETOUR
AHEAD

ROAD CLOSED
FOR LOCAL TRAFFIC ONLY

DETOUR
AHEAD

ROAD
CLOSED
AHEAD

DETOUR

DETOUR

Highland St

Highland St

Detroit St

Detroit St

Detroit St

Detroit St

Jackson Ave

Washington St

Dyer Blvd

Dyer Blvd

Garfield Ave

Harrison Ave

Van Buren Ave

Conkey St

Conkey St

Conkey St

Hohman Ave

Hyslop Pl

Park Pl

S Blaine Ave

Lewis St

Lewis St

Hohman Ave

Lyman Ave

Blaine Ave

Jackson Ave

Hohman Ave

Blaine Ave

Garfield Ave

Harrison Ave

Van Buren Ave

Jackson Ave

Glendale Park



Glendale Park

Wildwood Rd

Wildwood

HIGHLAND ST. EASTBOUND DETOUR

Legend

- Vehicle Detour - - - - -
- Work Zone 
- Type III Barricade 
- Traffic Pattern 

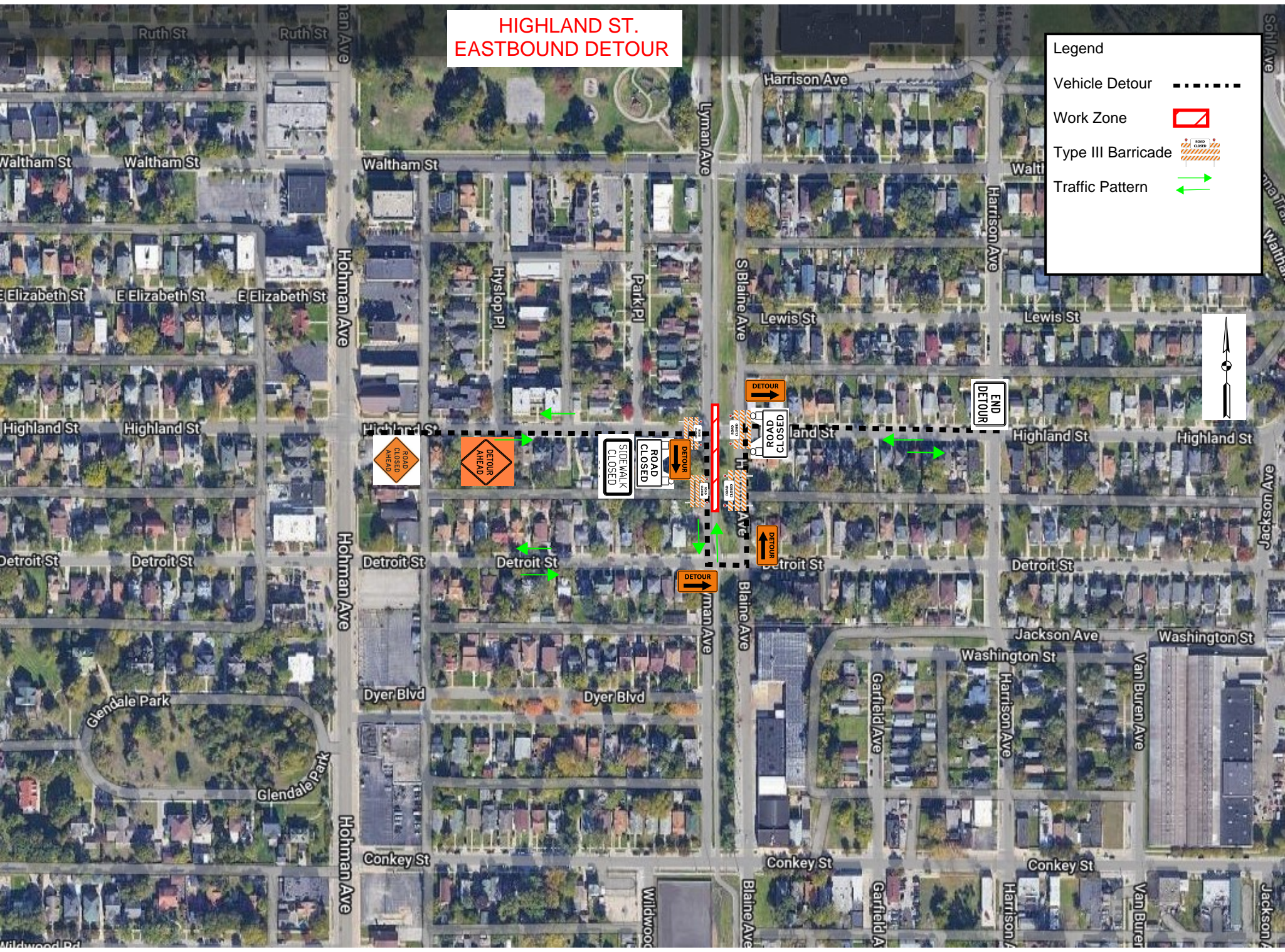
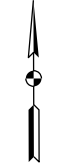

ROAD CLOSED AHEAD

DETOUR AHEAD

SIDEWALK CLOSED

ROAD CLOSED

ROAD CLOSED

DETOUR

END
DETOUR

DETOUR

DETOUR

DETOUR

DETOUR

DETOUR



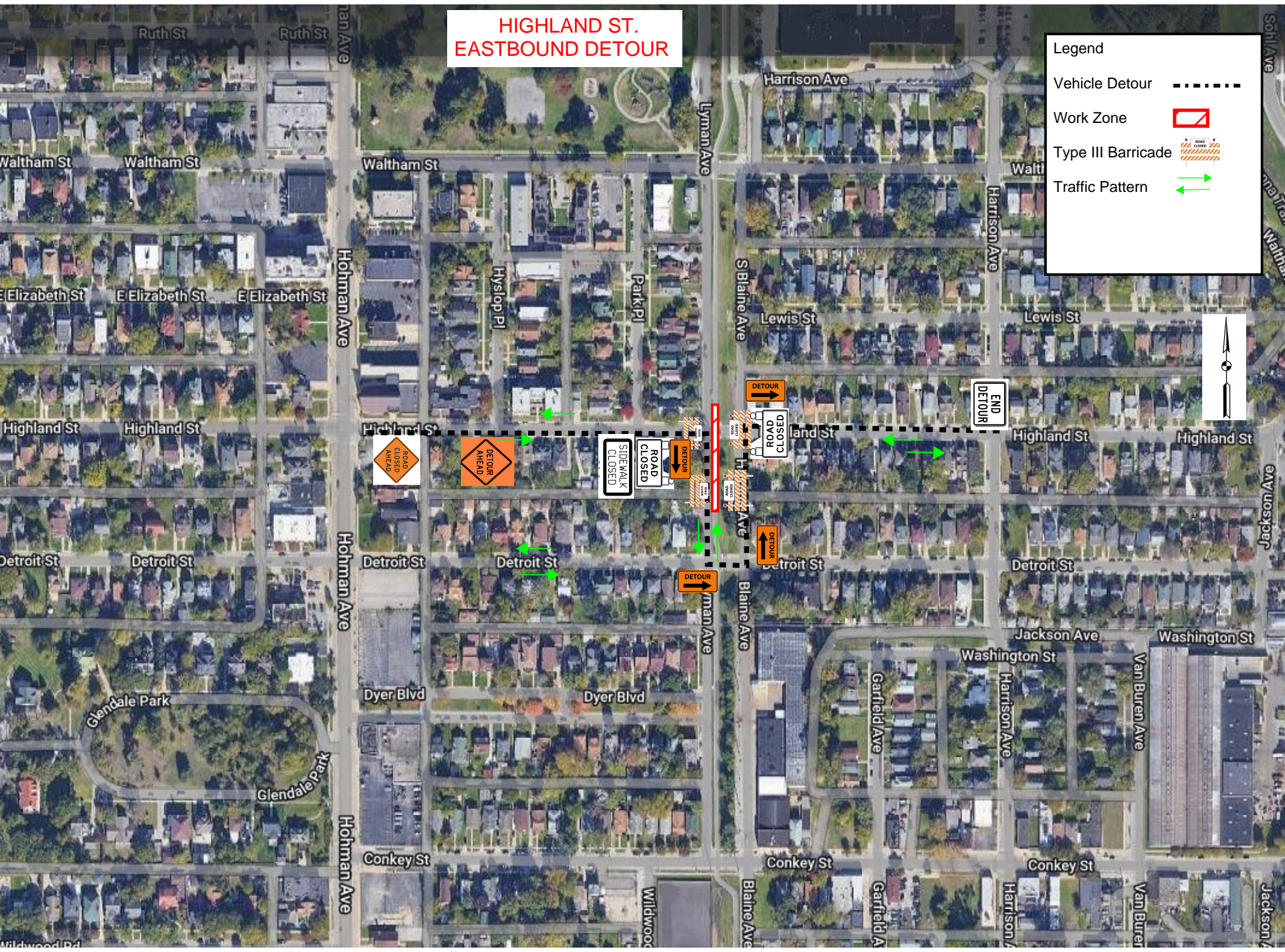

DETOUR

DETOUR



HIGHLAND ST. NORTHBOUND DETOUR



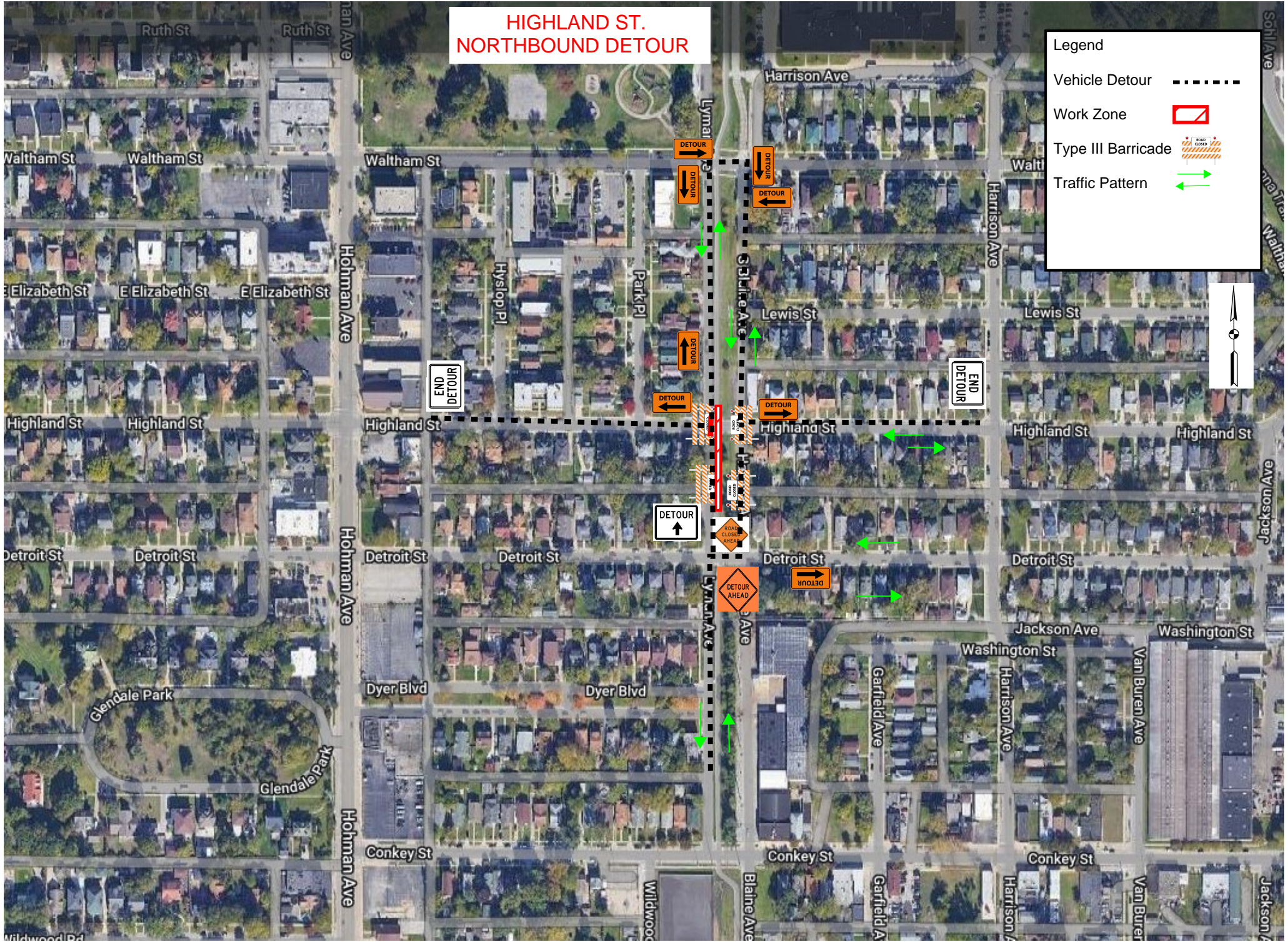

Legend

- Vehicle Detour 
- Work Zone 
- Type III Barricade 
- Traffic Pattern 



HIGHLAND ST. SOUTHBOUND DETOUR

Legend

- Vehicle Detour 
- Work Zone 
- Type III Barricade 
- Traffic Pattern 



END
DETOUR

END
DETOUR

DETOUR
AHEAD

ROAD
CLOSED
AHEAD

DETOUR

DETOUR

DETOUR

PLOT DATE: 8/18/2022 PLOT TIME: 12:39:30 PM
 FILE NAME: SHT-M-CI01-MTBA-03.dgn

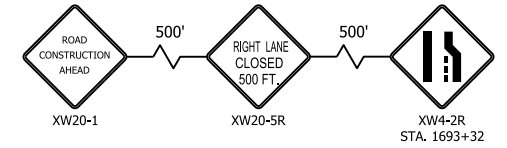
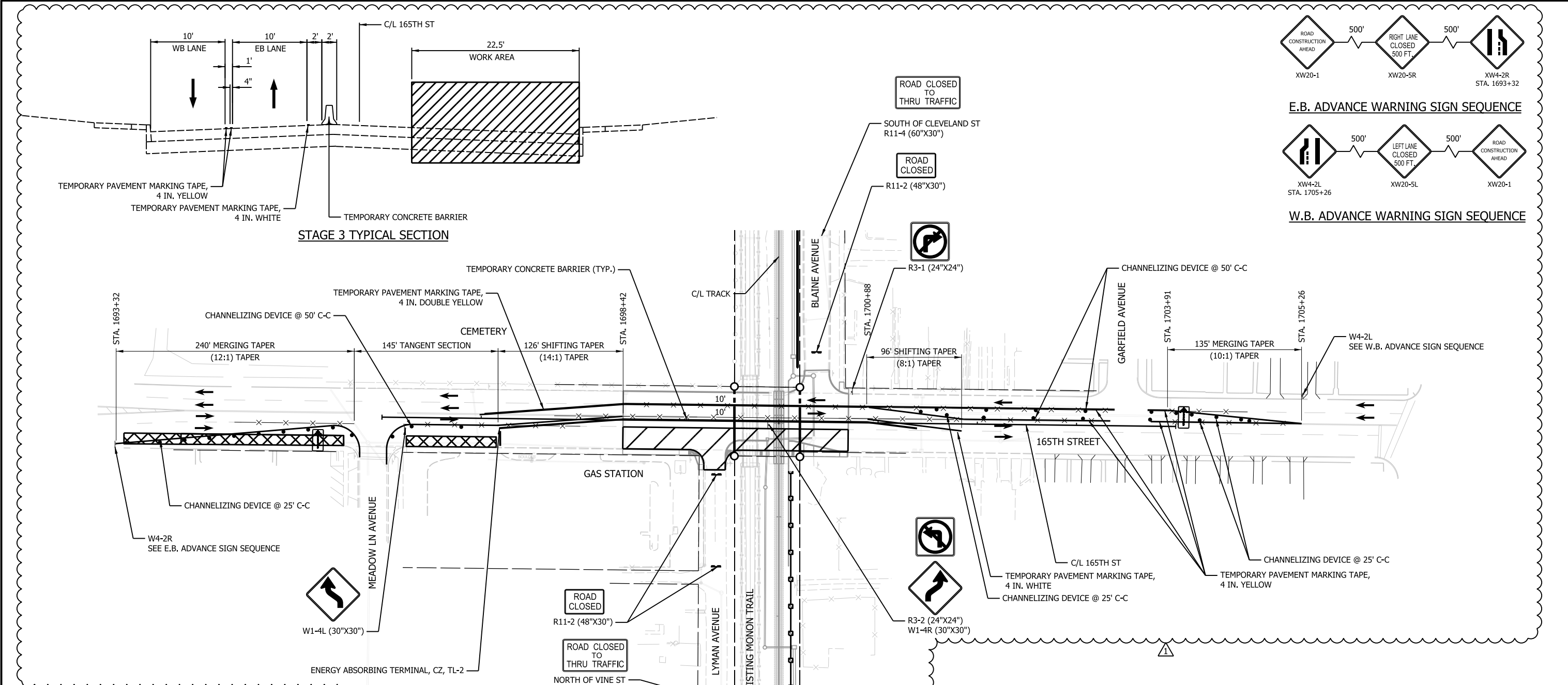

E.B. ADVANCE WARNING SIGN SEQUENCE

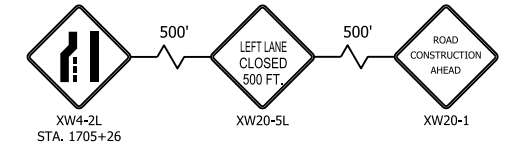

W.B. ADVANCE WARNING SIGN SEQUENCE

- LEGEND**
- CHANNELIZING DEVICE
 - ⬇️ FLASHING ARROW SIGN
 - TEMPORARY PAVEMENT MARKING
 - x— REMOVAL OF PAVEMENT MARKINGS AND PRISMATIC REFLECTORS
 - TYPICAL SIGN STANDARD (ROAD CLOSURE SIGN ASSEMBLY)
 - TYPE III BARRICADE
 - ➔ TRAFFIC FLOW
 - ▨ WORK AREA
 - ▩ PARKING LANE CLOSURE

MAINTENANCE OF TRAFFIC NOTES

- STAGE 3**
1. ESTABLISH AND MAINTAIN A DETOUR ROUTE FOR THE CLOSURE OF LYMAN AVENUE FROM NORTH OF VINE STREET TO 165TH STREET
 2. ESTABLISH AND MAINTAIN A DETOUR ROUTE FOR THE CLOSURE OF BLAINE AVENUE FROM CLEVELAND STREET TO 165TH STREET
 3. STAGE WILL CONSIST OF RECONSTRUCTION OF THE EASTBOUND LANES OF 165TH STREET FOR THE LENGTH OF ROADWAY LIMITS
 4. MAINTAIN ONE 10' LANE OF TRAFFIC IN EACH DIRECTION UTILIZING COMPLETED WESTBOUND PAVEMENT
 5. MAINTAIN POSTED 25 MPH SPEED LIMIT ON 165TH STREET
 6. SEE STD [G-CI01-GEDT-804](#) FOR MERGING OR SHIFTING TAPER DETAILS
 7. USE THIS MAINTENANCE OF TRAFFIC PLAN WITH IMUTCD TYPICAL APPLICATION TA-32
 8. 165TH ST AND CONKEY ST SHALL NOT BE CLOSED SIMULTANEOUSLY
 9. ELECTRONIC MESSAGE BOARDS GIVING NOTICE OF LANE CLOSURES REQUIRED TO BE PLACED TWO WEEKS IN ADVANCE OF CLOSURE

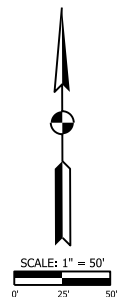

FHP F.H. PASCHEN
Ragnar Benson
 JOINT VENTURE

Jacobs

REVISIONS		
ISSUE	DATE	DESCRIPTION
1	08/19/2022	DCJ-0021 165TH ST CURB

NICD
 NORTHERN INDIANA COMMUTER
 TRANSPORTATION DISTRICT
 33 East Highway 12
 Chesterton, Indiana 46304

WEST LAKE
 CORRIDOR
 DYER TO HAMMOND, INDIANA

REGISTERED PROFESSIONAL ENGINEER
 KATELYN S. HACKER
 PE12200177
 INDIANA
 DATE: 8/18/22

BU:	M-CI01
DESIGNED:	A. SIPKOVSKY
DRAWN:	K. GOMEZ
CHECKED:	A. SIPKOVSKY
SCALE:	1"=50'
DATE:	05/11/2022

FINAL RFC PLANS DWG. NO. **M-CI01-MTBA-03**

**MAINTENANCE OF TRAFFIC
 165TH STREET - STAGE 3**

FOR CONSTRUCTION SHEET NO. **23 OF 205**

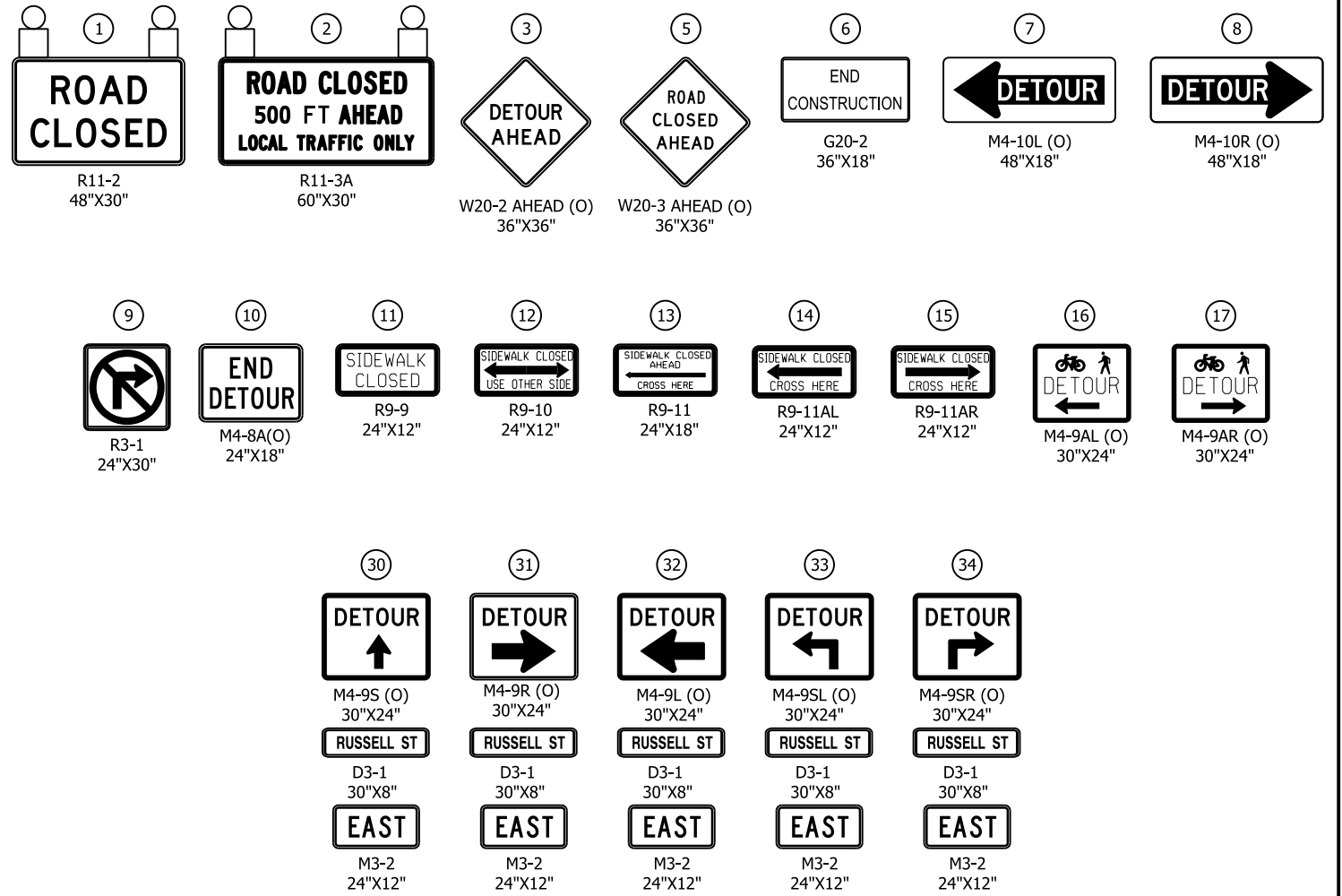
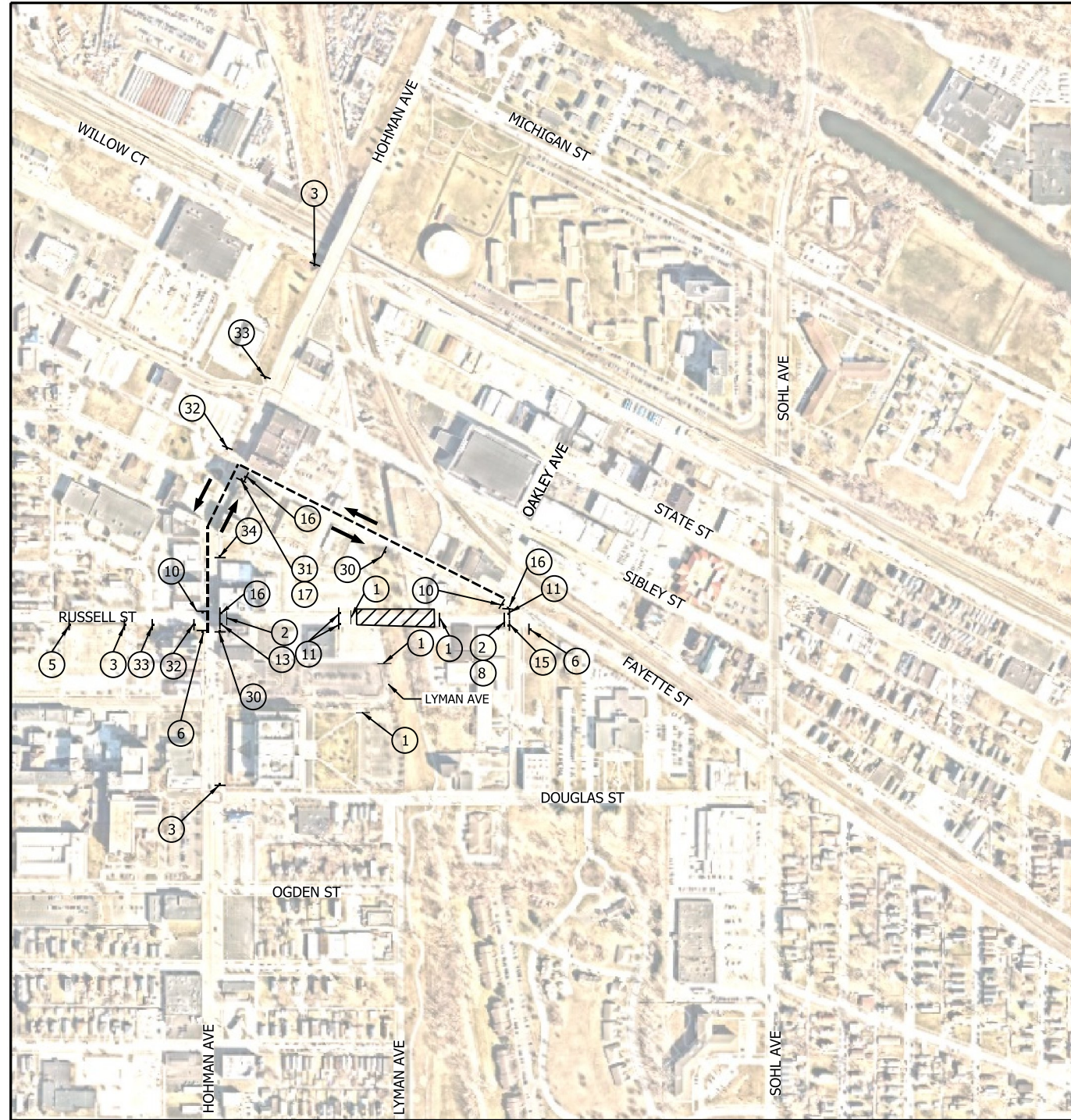

NOTES

- SIGN DESIGNATIONS ARE PER IMUTCD.
- SIGN LOCATIONS ARE APPROXIMATE. SEE BU G-C01 DWG NO. [G-CI01-GEDT-801](#), [G-CI01-GEDT-802](#), AND [G-CI01-GEDT-803](#) FOR SIGN PLACEMENT.
- SEE BU G-C01 DWG NO. [G-CI01-GEDT-820](#), [G-CI01-GEDT-821](#) AND [G-CI01-GEDT-822](#) FOR SIGN POST DETAILS.
- SEE BU G-C01 DWG NO. [G-CI01-GEDT-807](#) AND [G-CI01-GEDT-808](#) FOR TYPE III BARRICADE APPLICATION STANDARDS.
- THE CONTRACTOR SHALL MAINTAIN FREE PASSAGE OF PEDESTRIANS ON ONE SIDE OF RUSSELL STREET WHEN PRACTICABLE.
- RUSSELL STREET IS CURRENTLY A ONE-WAY STREET EASTBOUND. PRIOR TO ANY WORK SPACE CLOSURES ON RUSSELL STREET, CONVERT TO TWO-WAY AND PLACE THE PROPOSED SIGNS AS SHOWN ON THE 'SIGNING AND PAVEMENT MARKING' PLAN FOR RUSSELL STREET ON [DWG NOS. N-CI05-RDSN-02](#), [N-CI05-RDSN-03](#), [N-CI05-RDSN-04](#).
- LYMAN AVENUE IS THE ONLY OUTLET FROM THE FEDERAL PLAZA PARKING LOT. SEE DWG NOS. [N-CI05-MTPI-07](#) AND [N-CI05-MTPI-08](#) FOR LOT DETOUR INFORMATION.

LEGEND

- TYPE III BARRICADE
- SIGN
- DETOUR ROUTE
- DIRECTION OF TRAFFIC
- WORK SPACE
- ORANGE
- TYPE B LIGHT

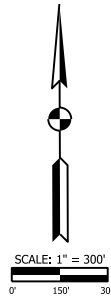

PLOT DATE: 4/25/2022 PLOT TIME: 10:29:00 AM
FILE NAME: SHT-N-CI05-MTPI-02.dgn



JACOBS

REVISIONS		
ISSUE	DATE	DESCRIPTION



BU:	N-CI05
DESIGNED:	A. SIPKOVSKY
DRAWN:	S. KOZLOWSKI
CHECKED:	A. SIPKOVSKY
SCALE:	1"=300'
DATE:	05/03/2022





FINAL RFC PLANS DWG NO. N-CI05-MTPI-02

**MAINTENANCE OF TRAFFIC
DETOUR PLAN - RUSSELL STREET**

FOR CONSTRUCTION SHEET NO. 10 OF 62

DETROIT ST. WESTBOUND DETOUR

Legend

- Vehicle Detour 
- Work Zone 
- Type III Barricade 
- Traffic Pattern 



END
DETOUR

DETOUR

DETOUR

DETOUR

DETOUR

DETOUR
AHEAD

ROAD CLOSED
500 FT AHEAD
LOCAL TRAFFIC ONLY

DETOUR
AHEAD

ROAD
CLOSED
AHEAD

DETROIT ST. EASTBOUND DETOUR

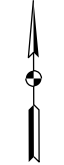

Legend

- Vehicle Detour
- Work Zone
- Type III Barricade
- Traffic Pattern



DETROIT ST. NORTHBOUND DETOUR

Legend

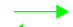
- Vehicle Detour 
- Work Zone 
- Type III Barricade 
- Traffic Pattern 



DETOUR

DETOUR

DETOUR

DETOUR



END
DETOUR

ROAD
CLOSED
AHEAD

DETOUR
AHEAD

DETROIT ST. SOUTHBOUND DETOUR

Legend

- Vehicle Detour - - - - -
- Work Zone 
- Type III Barricade 
- Traffic Pattern 